



COMHAIRLE CONTAE AN CHLÁIR  
CLARE COUNTY COUNCIL



# Incorporating Nature-based SuDS into a public realm URDF funded project

**Leonore O'Neill**  
**Senior Executive Officer**  
**Ennis Municipal District**

# Ennis

- Largest town in Munster – Population 25,000
- Ennis Town Centre is distinguished by its medieval townscape character of narrow streets, laneways and traditional buildings, complemented by the natural qualities of the River Fergus.
- The town centre is designated a Recorded Monument, is an Architectural Conservation Area (ACA) and is immediately adjacent to an Special Area of Conservation (SAC).
- Irelands Tidiest Town 2021
- Finalist Irelands Friendliest Town 2021



# Aims of Public Realm Enhancement

Overall aim Ennis Public realm enhancement is to boost economic activity through

- Improved Accessibility

- Universal Accessibility
- Shared Surface
- Cycle Infrastructure
- Reduce Clutter

- Increased dwell-time

- Creation of Civic Spaces
- Seating
- Interactive Fountain
- Greening

This should lead to increased pedestrian footfall, street activity and property value, and a longer stay by shoppers and visitors. It also increases the attractiveness of the urban centre and enhances community pride and sense of place.



# Ennis Town Centre URDF Co-Funded Projects

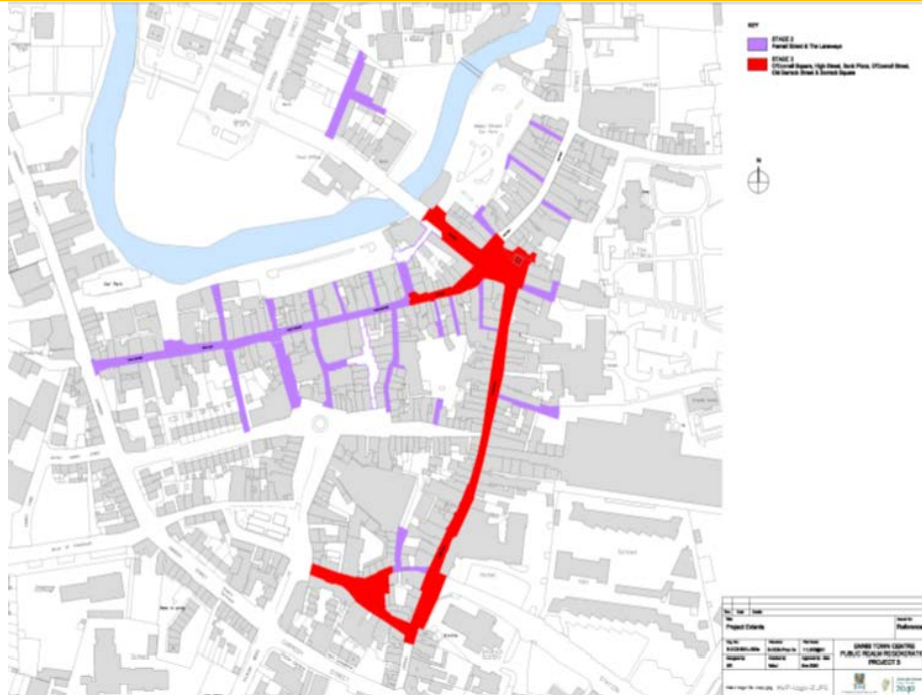

## Interventions

- Shared surface treatment
- Provision of defined loading bays and disabled parking
- Widened footpaths
- High quality surface materials with improved street furniture, lighting and signage
- Public Art
- Interactive pavement fountain as central feature
- Street trees
- Demountable light-weight structures for special events
- Rain garden



# Challenges in Ennis Public Realm Design

- Historic town – ACA, adjacent to SAC, narrow streets
- Universal Accessibility
- Congested underground services
- Levels / Falls
- Traffic Management
- Deliveries
- Parking



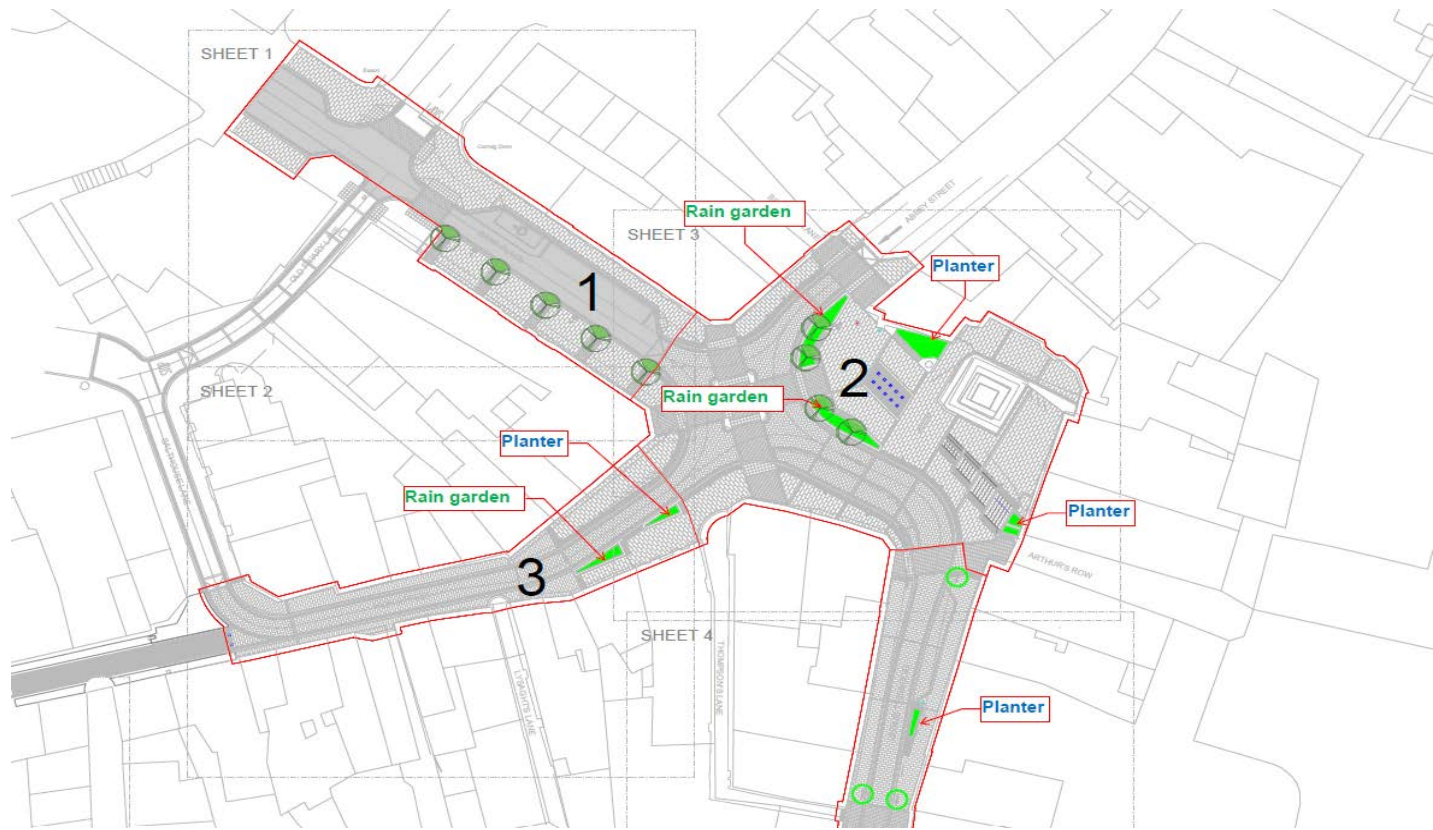

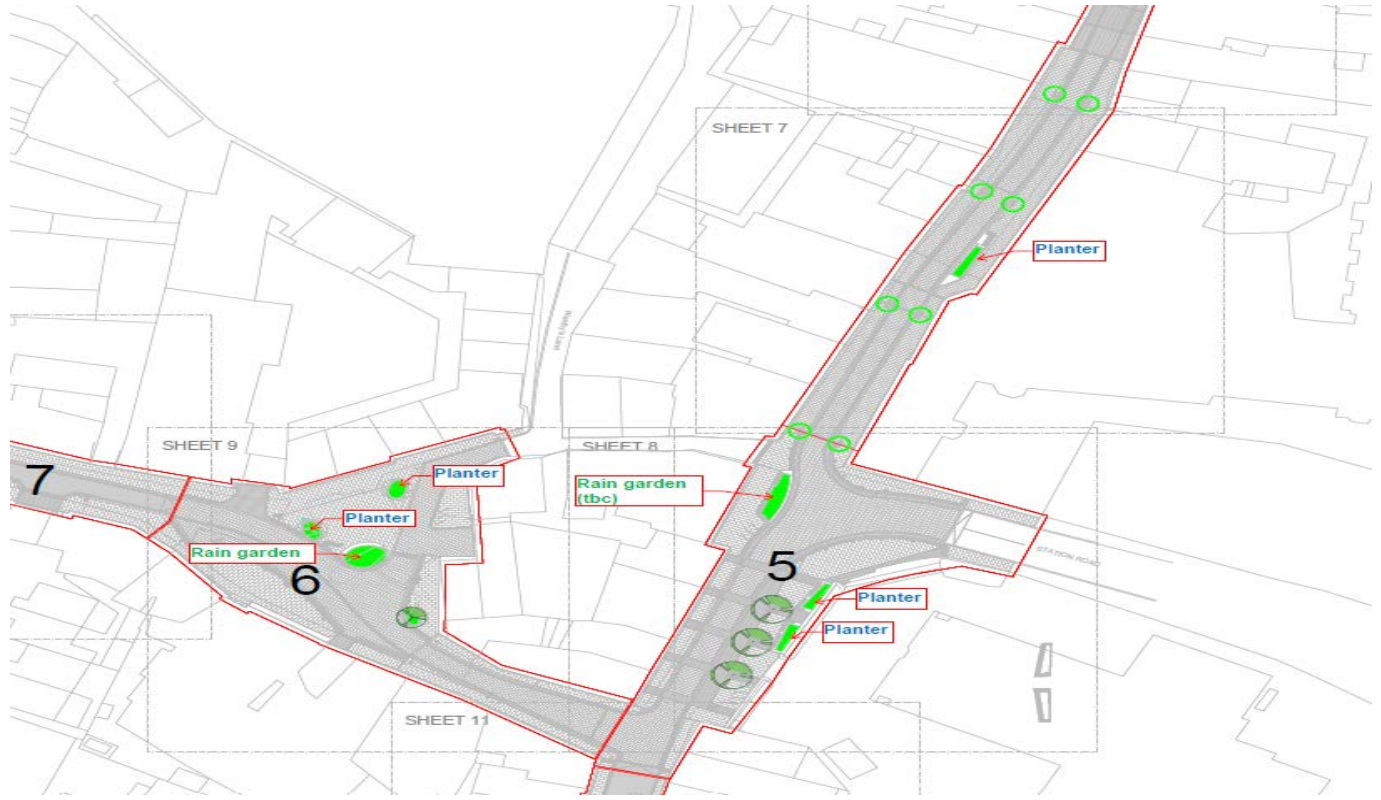

# Considerations for Raingardens

- Choose the right location
- Composition of a rain garden
- Calculate the size and depth
- Consider infiltration
- Manage Flows
- Select the planting





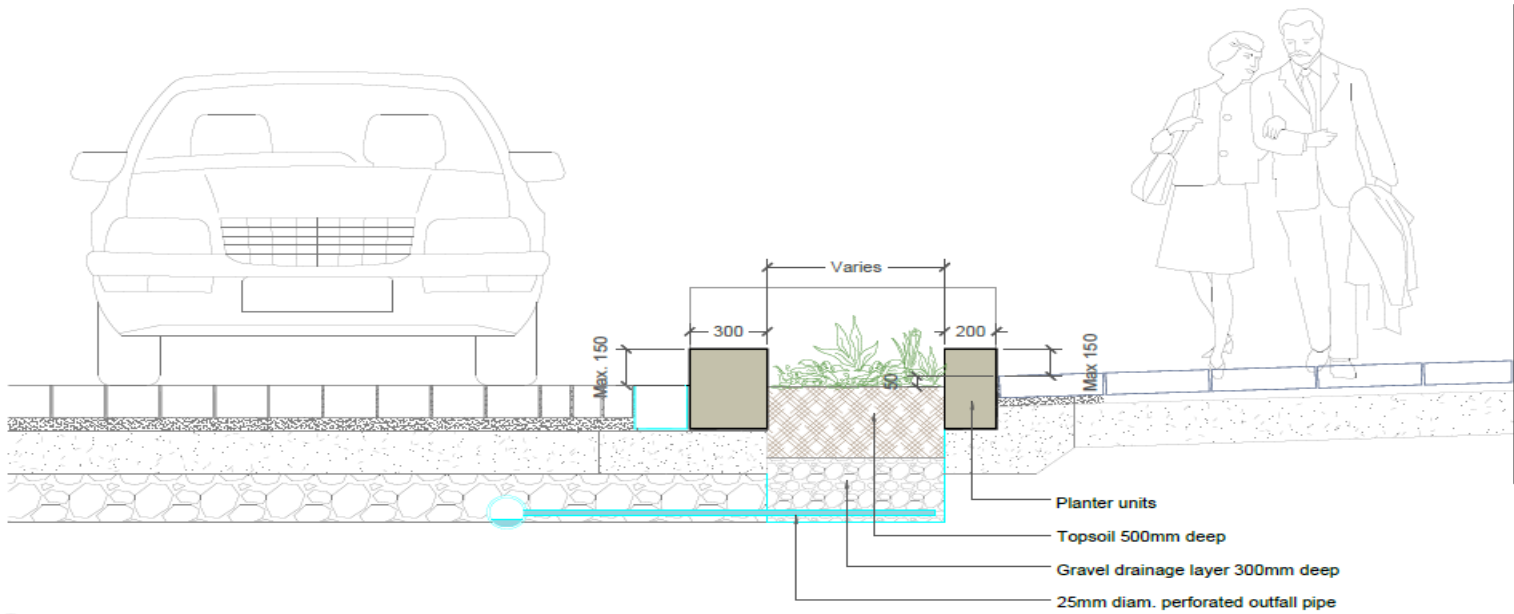

17 Rain Garden  
C-014 Typical Section

# O'Connell Street



# O'Connell Street



# Cathedral

